

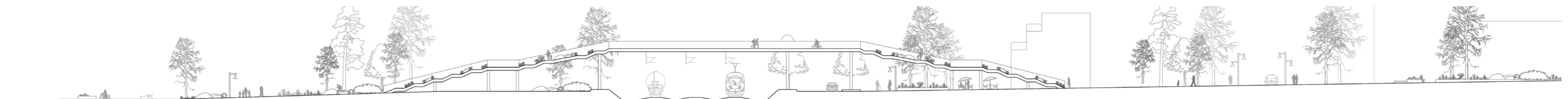

A. PIER PLAZA LONGITUDINAL SECTION



B. SUNSET BRIDGE PEDESTRIAN OVERPASS

1. MOBILITY AS COMMONS

The movement of people and goods is celebrated as an essential aspect of the city's lively character. Piteå new system of public connections ensures a harmonious coexistence of mobility and urban life. Underpasses, overpasses, streets which represent the city's connective system are considered public grounds and all contain activating programs and become an inherent destination, not just a point of passage. For example the Plaza-Pier bridges the city center with the waterfront is a space active during all seasons.

TRANSPORTATION HUB
The transportation hub with train and bus station are adjacent to the new heart of Piteå - right in-between the old and the new, city and sea. Train station and bus station are directly connected to the city through the PIER-PLAZA. The train station works as a mobility exchange on multiple levels, bridging the tracks and Timmerleden. The train station is on two levels, with the main entrance from the plaza directly under the tracks and one entrance on ground level near the bus station. Its a three track system with middle functioning platform.

EXPO TRAIN TRACK EXIT
To better serve West Piteå a second train track exit and underpass is created north of the new Expo allowing direct reach of the bus and train station from this office and leisure area.

UNDERPASSES AND OVERPASSES AS PUBLIC SPACE
Timmerleden and the North Bothnia Line train tracks are kept at ground level. Underpasses and overpasses bridge these transport lines and they are designed as true public spaces.

EAST UNDERPASS
Bicycle connections through Piteå are important. We are creating two bike lanes; a fast one parallel to Timmerleden and a scenic route along the waterfront. From Northeast Piteå both bicycles and pedestrians can take an underpass to reach the active waterfront.

2. PUBLIC SPACE FOR ALL SEASONS

A weave of differently sized open spaces, roads, routes, playgrounds and green areas spreads out in the existing and new neighbourhoods of Piteå. The function of connection always goes hand in hand with activity and public space.

PIER-PLAZA
The new heart of Piteå suited for activities and with commercial ground floors is the Pier Plaza, it becomes an all year activity and shopping destination. Its a grandiose space that can host large numbers of people gathering for Piteå Summer Games, Festspelen or the next Scandinavian Cup. Small intimate spaces with interactive play, seats for observations and pockets of nature are designed to allow for being alone and together at the same time. The PIER-PLAZA connects the city centre by passing under the mirror dressed roof of Timmerleden and the tracks with Sörfjärden and its new leisure expo and office area and the waterfront areas.

SEASONAL CHANGES
Public spaces with space for activities in both summer and winter, water pools become ice rinks, green slopes for sunbathing are perfect for snow sliding. The library of goods which helps with the equal access to fun and activities all round the year is placed along the waterfront. Here one can borrow fishing, camping, water gear in summer and skates, skis, and sliding gear in winter. In winter heated paths in-between the snow mountains will create a new experience of the big public spaces from summertime.

SUNSET BRIDGE
The existing pedestrian route on Uddmångsgatan will be extended all the way to the waterfront. The Sunset Bridge overpasses the new train tracks and Timmerleden for pedestrians with steps and ramps. The top of the bridge will offer a new scenic viewpoint over the whole of Sörfjärden. Large steps takes you down to the new public bath house / ice-rink with café that also offers a terrace on the roof out in the water.

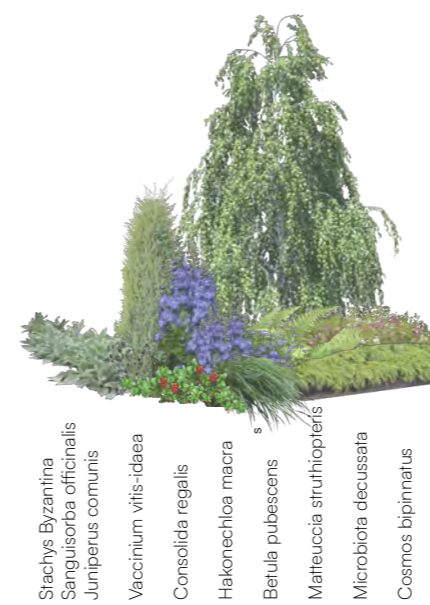
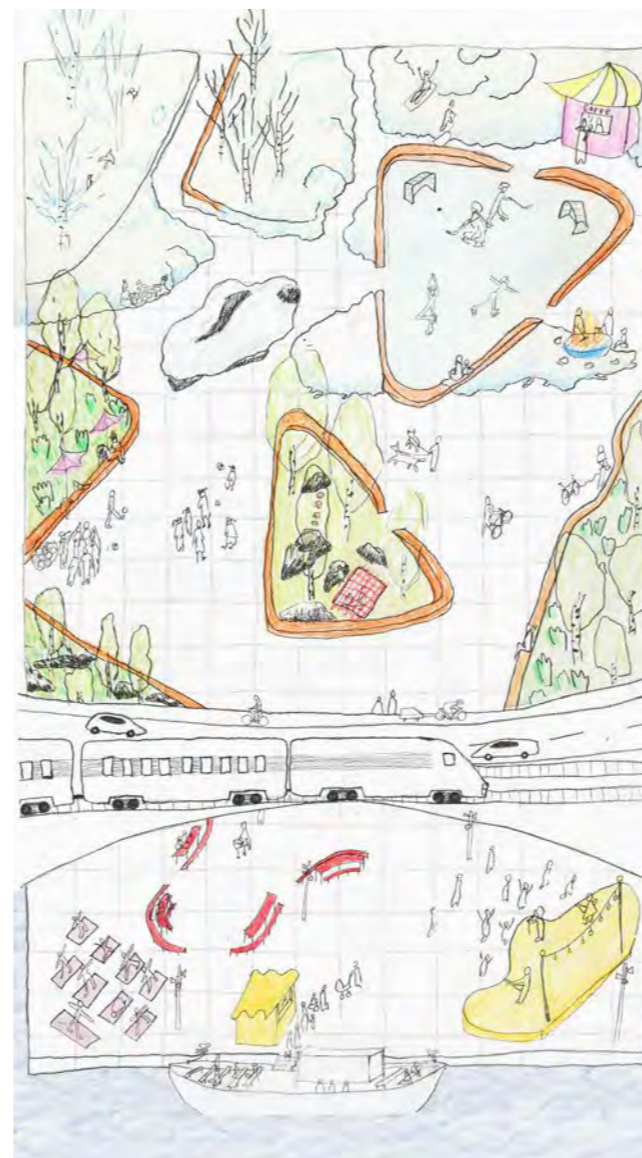

Salix pyramidalis
Salix caprea
Juniperus communis
Vaccinium vitis-idaea
Coronilla regalis
Halimolobos maritima
Betula pubescens
Marrubium angustifolium
Microbita discusata
Cornus sibirica



Hippogonum maritimum
Betula pubescens
Elaeagnus communita
Scorbinus auribolis
Salix fragilis "Pulchra"
Salix repens
Sparganium angustifolium
Halimolobos maritima



Local stone Gabbro to be incorporated in the square

THE WATERFRONT A (bio)diverse belt

The strip is designed and structured to stretch from a more built and urban part by the train plaza towards a slowly increased vegetated, natural part in the east. This gradient encourage mixed usages and becomes attractive for diverse set of activities. The east part of the waterfront is divided into three zones; open recreation spot, outdoor lounge for young adults and playground area for children. These three functions are aimed to blend and overlap while still offering a set located spot.

PIER PLAZA A green meeting point all year round

To add colour and warmth, evergreen plants that can withstand drought and are easy to maintain due to underpassing planting are selected to create an all year experience. The sheltered micro-climate provides a habitat suitable for zone 5 with Nordic classics such as lingonberry and juniper. The plaza holds organic blocks of flowerbeds that are planned as wild oases yet thoroughly organized.

ULTRALOCAL Using local materials and native plants

Using local stone in building construction and landscaping reduces transport emissions, minimizing the carbon footprint. Embracing region-specific materials supports local quarries and industries boosting the regional economy and fostering a sense of community pride.

